

28-SEP-2016 14:02  
 C:\User\jibconner\Documents\CURRENT PROJECTS\AST\2017-2018 AST\Northampton\DA00XXX\_psh.dgn  
 jibconner AT DICAD270263  
 09/08/19

**CONTRACT: DA00326 WBS PROJECT: 2017CPT.01.17.20662.1**

STATE OF NORTH CAROLINA  
 DIVISION OF HIGHWAYS

# NORTHAMPTON COUNTY

STATE	STATE PROJECT REFERENCE NO.	SHEET NO.	TOTAL SHEETS
N.C.	2017CPT.01.17.20662.1	1	
STATE PROJ. NO.	F. A. PROJ. NO.	DESCRIPTION	
2017CPT.01.17.20662.1		MAP 1	
2017CPT.01.17.20662.1		MAP 2	
2017CPT.01.17.20662.1		MAP 3	
2017CPT.01.17.20662.1		MAP 4	
2017CPT.01.17.20662.1		MAP 5	
2017CPT.01.17.20662.1		MAP 6	
2017CPT.01.17.20662.1		MAP 7	
2017CPT.01.17.20662.1		MAP 8	



**LOCATION:** MAP #1 SR 1106 FROM NC 308 TO DEAD END  
 MAP #2 SR 1113 FROM SR 1109 TO DEAD END  
 MAP #3 SR 1114 FROM SR 1113 TO DEAD END  
 MAP #4 SR 1511 FROM SR 1501 TO DEAD END  
 MAP #5 SR 1125 FROM SR 1108 TO DEAD END  
 MAP #6 SR 1131 FROM SR 1108 TO END OF MAINTENANCE  
 MAP #7 SR 1328 FROM SR 1300 TO SR 1333  
 MAP #8 SR 1313 FROM DEAD END TO END OF PAVEMENT

**TYPE OF WORK: ASPHALT SURFACE TREATMENT DOUBLE SEAL**

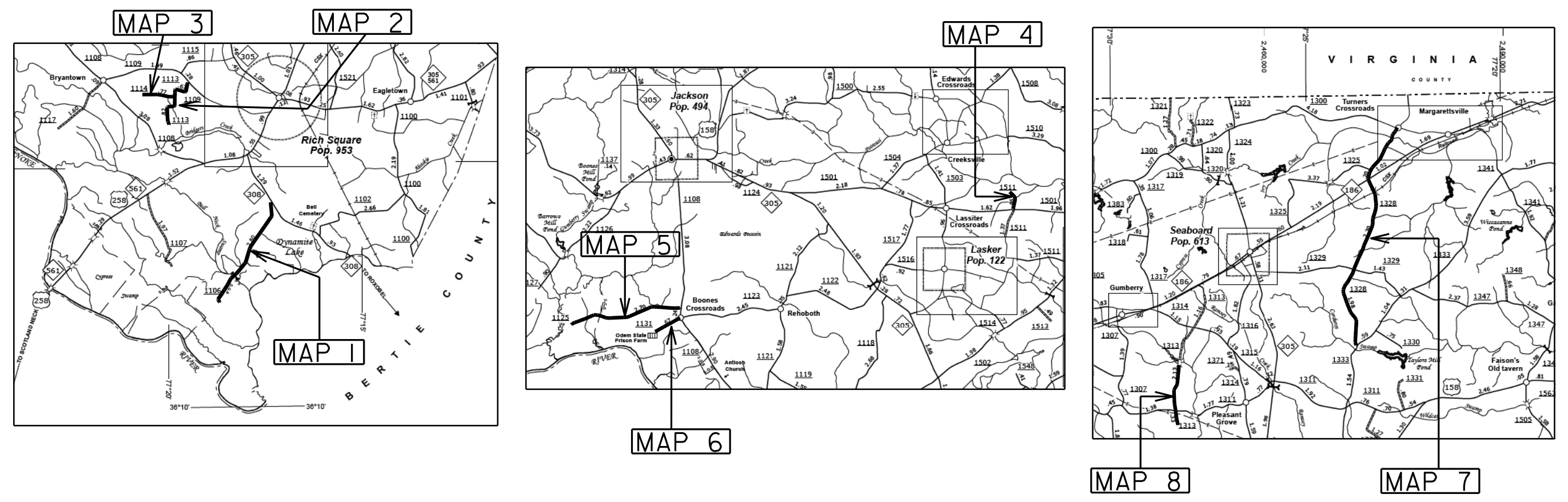

NTS

**PROJECT LENGTH**

- LENGTH OF ROADWAY PROJECT MAP 1 = 2.80 MI.
- LENGTH OF ROADWAY PROJECT MAP 2 = 1.49 MI.
- LENGTH OF ROADWAY PROJECT MAP 3 = 0.77 MI.
- LENGTH OF ROADWAY PROJECT MAP 4 = 0.46 MI.
- LENGTH OF ROADWAY PROJECT MAP 5 = 2.20 MI.
- LENGTH OF ROADWAY PROJECT MAP 6 = 0.67 MI.
- LENGTH OF ROADWAY PROJECT MAP 7 = 6.59 MI.
- LENGTH OF ROADWAY PROJECT MAP 8 = 1.53 MI.

Prepared in the Office of:  
**DIVISION OF HIGHWAYS**

113 Airport Dr., Edenton NC, 27932

2012 STANDARD SPECIFICATIONS

LETTING DATE:

**W.B. HOBBS, P.E.**  
 DIVISION PROJECT MANAGER

**C.E. SLACHTA**  
 DIVISION PROPOSALS ENGINEER

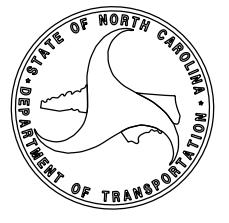

P A V E M E N T   S C H E D U L E

C1	PROP. ASPHALT SURFACE TREATMENT, DOUBLE SEAL, AT AN APPLICATION RATE TO BE DETERMINED BY FIELD CONDITIONS IN ACCORDANCE WITH PROJECT SPECIAL PROVISIONS.
U	EXISTING PAVEMENT.

NOTES:

\*ALL PAVED S.R. ROADS TO BE TREATED TO THE ENDS OF THE RADII,  
OR AS DIRECTED BY THE ENGINEER

\*PAVEMENT MARKINGS TO BE PERFORMED BY OTHERS

\*ASPHALT SURFACE TREATMENT, DOUBLE SEAL CONSISTS OF TWO LAYERS OF TREATMENT:

BOTTOM LAYER CONSISTS OF EMULSIFIED ASPHALT, GRADE CRS-2L AT A RATE OF APPROX  
0.30 ± GAL/SY AND A LAYER OF 7M AGGREGATE AT A RATE OF APPROX. 18 ± LBS/SY.

TOP LAYER CONSISTS OF EMULSIFIED ASPHALT, GRADE CRS-2L AT A RATE OF APPROX  
0.25 ± GAL/SY AND A LAYER OF 5/16" LIGHTWEIGHT AGGREGATE AT A RATE OF APPROX. 9 ± LBS/SY.

OR #9 AGGREGATE AT A RATE OF APPROX. 9± LBS/SY.

OR CA-9 LIGHTWEIGHT AGGREGATE AT A RATE OF APPROX. 9± LBS/SY.

\*CONTRACTOR SHALL BE RESPONSIBLE FOR LOADING, HAULING, AND PLACING ALL MATERIALS.

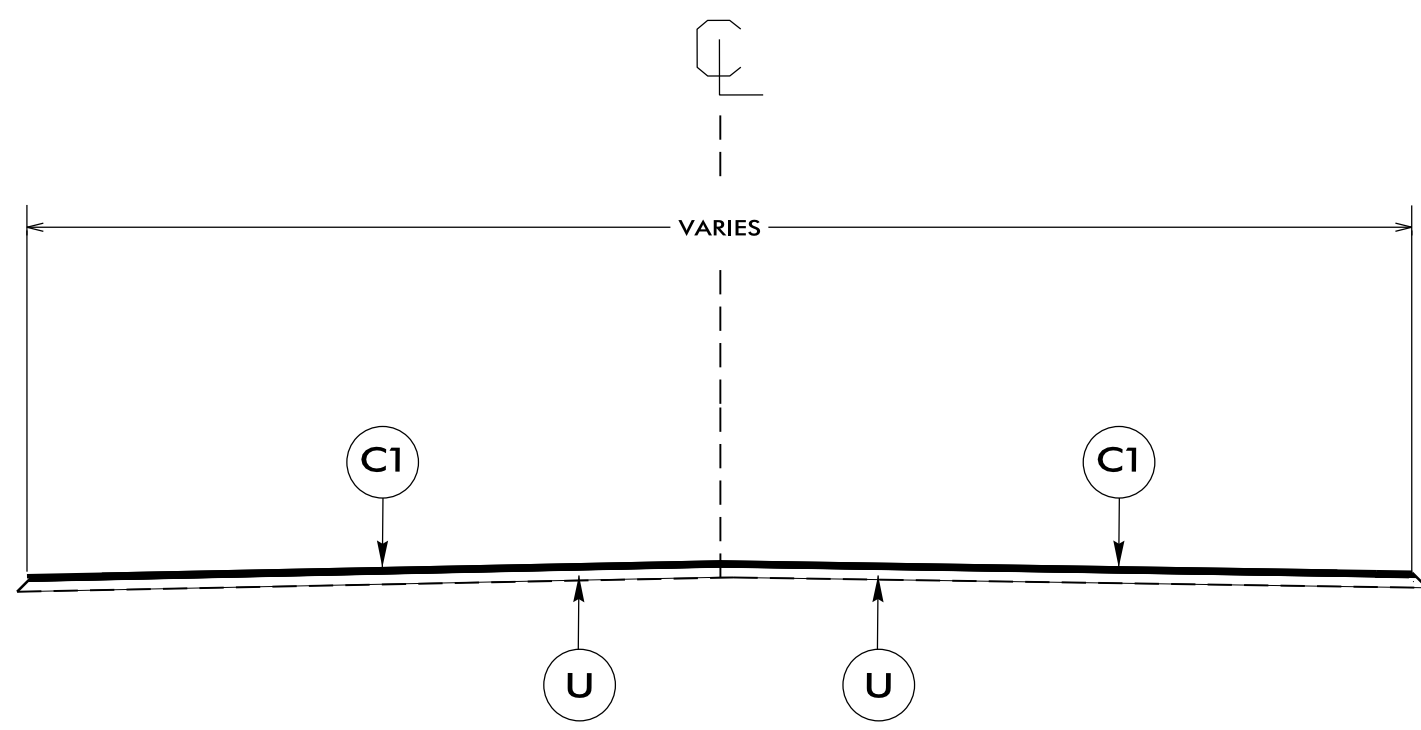

**TYPICAL SECTION NO. 1**

**USE WITH MAPS 1 THRU 8**

NTS

03-OCT-2016 14:53  
 C:\Users\jbochner\Documents\CURRENT PROJECTS\AST 2017-2018 AST\DA00326-Nor-thampton\DA00326-psh.dgn  
 11/11/2016 10:25:31

PROJECT NO.	SHEET NO.	TOTAL NO.
2017CPT.01.17.20662.1	3	

## SUMMARY OF QUANTITIES

PROJECT NO	COUNTY	MAP NO	ROUTE	DESCRIPTION	TYP NO	LANES	LANE TYPE	LENGTH MI	WIDTH FT	MOBILIZATION LS	ASPHALT SURFACE TREATMENT, DOUBLE SEAL SY	LATEX MODIFIED EMULSION FOR AST (CRS-2L) GAL	TEMP TRAFFIC CONTROL LS
2017CPT.01.17.20662.1	Northampton	1	SR 1106	FROM NC 308 TO DEAD END	1	2	2WU	2.80	18	1	30,368	16,702	1
2017CPT.01.17.20662.1	Northampton	2	SR 1113	FROM SR 1109 TO DEAD END	1	2	2WU	1.49	20	*	17,883	9,836	*
2017CPT.01.17.20662.1	Northampton	3	SR 1114	FROM SR 1113 TO DEAD END	1	2	2WU	0.77	18	*	8,131	4,472	*
2017CPT.01.17.20662.1	Northampton	4	SR 1511	FROM SR 1501 TO DEAD END	1	2	2WU	0.46	18	*	4,858	2,671	*
2017CPT.01.17.20662.1	Northampton	5	SR 1125	FROM SR 1108 TO DEAD END	1	2	2WU	2.20	20	*	26,613	14,637	*
2017CPT.01.17.20662.1	Northampton	6	SR 1131	FROM SR 1108 TO END OF MAINTENANCE	1	2	2WU	0.67	22	*	8,647	4,756	*
2017CPT.01.17.20662.1	Northampton	7	SR 1328	FROM SR 1300 TO SR 1333	1	2	2WU	6.59	20	*	79,723	43,848	*
2017CPT.01.17.20662.1	Northampton	8	SR 1313	FROM DEAD END TO END OF PAVEMENT	1	2	2WU	1.53	18	*	16,557	9,106	*
<b>GRAND TOTAL</b>													
								<b>16.51</b>		<b>1</b>	<b>192,780</b>	<b>106,028</b>	<b>1</b>

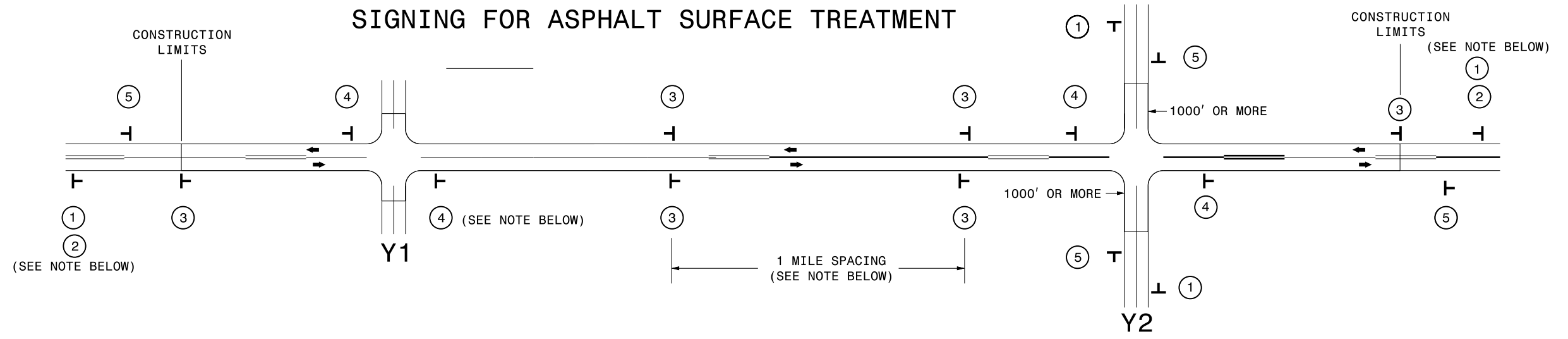

**LEGEND**  
 T STATIONARY SIGN  
 ← DIRECTION OF TRAFFIC FLOW

### MAINLINE (-L-) SIGNING

### -Y- LINE SIGNING

<b>SIGNING NOTES AND PLACEMENT PER DIRECTION</b>	①		PLACE 1000' PRIOR TO BEGINNING OF CONSTRUCTION LIMITS. ONLY USED ON -Y- LINES IF RESURFACING LIMITS EXTEND 1000' ALONG -Y- LINE.
	②		#2 SIGN ONLY USED WHEN RESURFACING LIMITS ARE 2 OR MORE MILES IN LENGTH. ROUND UP TO NEXT WHOLE NUMBER. (NO FRACTIONAL OR DECIMAL NUMBERS)
	③	 	ALTERNATE THE FOLLOWING TWO SIGNS: STARTING WITH "LOOSE GRAVEL" (W8-7) FOLLOWED BY "UNMARKED PAVEMENT". PLACE INITIALLY AT THE CONSTRUCTION LIMITS AND SPACED 1 MILE APART THEREAFTER. IF NO -Y- LINES EXIST, PLACE 2ND SET 1/2 MILE FROM THE CONSTRUCTION LIMITS AND THEN SPACE 1 MILE THEREAFTER.
	④		THESE ARE FOR -Y- LINES THAT ARE "THROUGH" ROADWAYS. DEAD END AND SUBDIVISION ROADS ARE NOT "THROUGH" ROADWAYS. INSTALL 500' +/- FROM EACH -Y- LINE APPROACH AS SHOWN ABOVE. FOR MULTIPLE -Y- LINES THAT ARE SEPARATED BY 0.25 MILES OR LESS, TREAT AS A SINGLE UNIT AND INSTALL WITHIN 500' OF EACH APPROACH. A MAXIMUM OF 2 SIGN SETS PER MILE. DO NOT INSTALL WHEN -Y- LINES ARE WITHIN 0.5 MILES FROM "END ROAD WORK" SIGN.
	⑤		PLACE 500' FOLLOWING THE END OF CONSTRUCTION LIMITS.

NO REQUIRED STATIONARY SIGNING FOR THE FOLLOWING -Y- LINE CONDITIONS:

- 1) LESS THAN 1000' OF RESURFACING ALONG -Y- LINE
- 2) SUBDIVISION ROADS
- 3) DEAD END ROADS

WHEN PAVING/CONSTRUCTION ACTIVITIES PROCEED ACROSS AN UNSIGNED -Y- LINE, ADVANCE WARNING PORTABLE SIGNS SHALL BE USED ALONG THE -Y- LINE AS SHOWN BELOW. REMOVE UPON COMPLETION OF WORK.

W20-1  
48" X 48"

W20-7 A  
48" X 48"

PLACED 500' IN ADVANCE OF FLAGGER. PLACED 250' IN ADVANCE OF FLAGGER.

**ADVANCE WARNING SIGNS FOR ASPHALT SURFACE TREATMENTS 2 LANE ROADWAYS**

30-SEP-2016 09:43 C:\User's\jocost\Documents\CURRENT PROJECTS\ASTV\2017-2018 AST\DA00326-Nor-hamp\ton\DA00326\_psh.dgn